

“We love being able to see our children sitting at the dining

table, which sounds silly, but we could never do it before”

Prior to their kitchen redesign by Graham Baker, the McKennas were struggling with an awkward layout that cut off the dining area from the kitchen. Now, maple cabinetry takes centre stage in an inviting, open-plan scheme

CLASSIC

Maple cabinetry twinned with emerald accessories create the relaxing kitchen the McKenna family wanted

# Green glass of home



Chris and Jackie McKenna were thrilled when interior designer Madeline Templeton managed to breathe life back into their living room using calming aquamarine tones. So when the time came for the couple to think about rejuvenating their tired and basic kitchen, Madeline was the obvious choice so they asked her to work her magic once more on their home.

The McKennas and their three children, Lauren, 19, Gareth, 17, and Claire, 11, had moved into their new-build, detached house six years previously and inherited a simple, laminate design chosen by the builder. 'The units were white and fairly inoffensive, but what used to drive me mad was that they had sited a floor-to-ceiling cupboard in the middle of the kitchen, which made the room look much smaller, plus it had some hideous faux-stained glass doors that we hated,' recalls Chris, a clinical psychologist.

The couple were introduced to Suffolk-based kitchen designer Graham Baker at Baker & Baker by Madeline. She explained that Chris and Jackie were keen to use colours and materials that would complement the aqua tones in the sitting room and ensure a seamless transition from room to room. 'Having three children and two dogs meant space was very important to us,' says Chris, 'and although we knew the renovation would mean a lot of disruption, we were confident that the end result would be worth it.'

Graham designed a simple scheme using made-to-measure, Shaker-style cabinetry including a curved breakfast area and snack bar station where the unsightly large cupboard formerly stood. The light, maple furniture lends itself to a fresh, smart look and complements their choice of jade and seagreen accents around the room. 'Jackie is very pleased with all the storage space she has now, especially the rounded, glazed cupboard, although she's always looking for something new to display in it,' laughs Chris. 'The children love the new design, too, and are quite happy to congregate in the kitchen while our evening meal is prepared. We like being able to see them sitting at the dining table doing their homework, which sounds silly, but we could never do it before.'



*A curved-end maple cabinet with glass doors softens the division between the kitchen and the dining area, and is backlit to display Jackie's assortment of glassware. The walls are painted in Chinese Jade by Dulux for a fresh, airy feel*



▲ A stylish ring-pull-lever tap with pull-out spout complements the kitchen's sleek lines and matches Jackie's stainless-steel appliances



▲ The Angola Black granite-topped, two-tiered breakfast bar is the perfect place for the children to make a snack after school and keeps them out of the kitchen's main preparation area. The Ice Bar stools from John Lewis offer a handy place for Jackie to sit with a mid-morning coffee

▶ Pull-out, stainless-steel racks put a stop to fumbling in cupboards for pots and pans. Here, saucepans can be matched with their lids and bakeware is easily retrievable. The smooth side runners ensure that lids stay on top of the pans when the racks are pushed shut. The muted Ardesia Dorata porcelain floor tiles from Smith & Wareham are the perfect partner to the maple cabinetry



“My favourite design element is the granite-topped breakfast bar. It's a real talking point with our guests and the curved shape draws you into the room”  
Chris McKenna

▶ Jackie says the warming drawer is one of her most useful appliances. 'It seems incredible that such a small drawer could hold plates for a dinner party of 12,' she smiles



Mirrored plinths studded with LED spotlights give the illusion that the maple cabinetry is floating above the floor tiles



## THE KITCHEN FILE

### DESIGN & CABINERY

- Graham Baker at **Baker & Baker**, Bench Barn Farm, Stoke Road, Clare, Suffolk CO10 8HQ (01787 277379) [www.bakerandbaker.co.uk](http://www.bakerandbaker.co.uk)
- Bespoke Shaker-style solid maple

### WORKTOPS

- Angola Black granite, Ivett & Reed. Price per linear m **£258**

### SINK & TAP

- LAX160 undermounted one-and-a-half-bowl sink in stainless steel, Franke **£360**
- Mythos single-lever mixer tap with pull-out nozzle, Franke **£318**

### APPLIANCES (shown)

- B1524 built-in single oven, Neff **£626**
- B6774 built-in multifunction oven, Neff **£806**
- B8722 built-in steam oven, Neff **£675**
- T4383 five-zone induction hob, Neff **£790**
- D5855 canopy extractor, Neff **£205**
- N7290 warming drawer, Neff **£356**

### APPLIANCES (not shown)

- Fully integrated fridge, Neff **£840**
- Fully integrated freezer, Neff **£346**
- Fully integrated dishwasher, Neff **£493**

▼ 'Our induction hob's fast-boil function is quicker than any kettle we've ever had,' says Chris. The glass splashback was spray-painted blue on the rear continuing the room's aqua theme

▼ These removable, wooden peg drawer organisers can be positioned to suit different crockery sizes and help to keep plates and bowls neatly stacked while preventing chipping and scratching. The units' bow handles are made from stainless steel

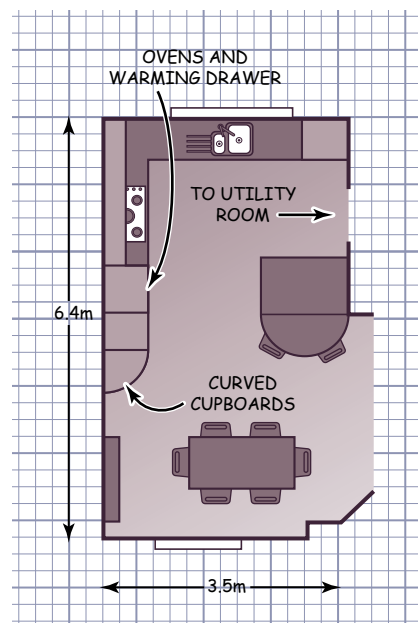

### GUIDE PRICE

- Starting price for a Baker & Baker kitchen **£20,000**

Where to buy Dulux 0870 444 1111 Franke 0161 436 6280 Ivett & Reed 01223 213500  
John Lewis 0845 604 9049 Neff 0870 513 3090 Smith & Wareham 01284 704188